



# County of Roanoke

## FINANCE DEPARTMENT PURCHASING DIVISION

Kate Hoyt, Buyer  
5204 Bernard Drive SW, Suite 300 F  
Roanoke VA 24018  
(540) 283-8149  
(540) 561-2829 – Fax  
[khoyt@roanokecountyva.gov](mailto:khoyt@roanokecountyva.gov)

February 18, 2019

### **IFB # 2019-047** **Demolition Services at Roanoke County's Explore Park**

### **ADDENDUM NO. 2**

**Asbestos Inspection Report at 3906 Rutrough Road**

Due Date & Time:  
**February 22, 2019, 2:00 PM**  
**(Local Prevailing Time)**

**IFB # 2019-047**  
**DEMOLITION SERVICES AT EXPLORE PARK**  
**ADDENDUM NO. 1**

1. **Asbestos Inspection Report** – Please see Attachment A to Addendum No. 2 for a copy of the asbestos inspection report for 3906 Rutrough Road, Roanoke VA (Site 4).

Bidders must include all relevant costs of remediation in the demolition cost for Site 4, on the Price Form for IFB 2019-047.

REMAINDER OF PAGE INTENTIONALLY LEFT BLANK

**ATTACHMENT A TO  
ADDENDUM NO. 2 TO IFB # 2019-047  
DEMOLITION SERVICES AT EXPLORE PARK**

**Asbestos Inspection Report at 3906 Rutrough Road**



**Solutions for all your Environmental and OSHA Concerns**

**February 18, 2019**

## **Asbestos Inspection Report**

### **Project Location:**

3906 Rutrough Road  
Roanoke, Virginia

### **Prepared For:**

Roanoke County  
Parks, Recreation & Tourism  
1206 Kessler Mill Road  
Salem, VA 24153

### **Prepared By:**

A handwritten signature in black ink, appearing to read "FDanner", is written over a horizontal line.

Fred Danner  
Asbestos Inspector

# **TABLE OF CONTENTS**

## **SCOPE OF WORK**

### **ASBESTOS INSPECTION**

- SAMPLE SUMMARY
- LABORATORY REPORT
- PHOTOS
- APPLICABLE LICENSES

## SCOPE OF WORK

HDH Technical, Inc. was contracted by The Roanoke County Department of Parks, Recreation and Tourism to provide an asbestos inspection at the structure located at 3906 Rutrough Road, Roanoke, Virginia. The inspection was conducted by personnel trained and licensed in accordance with the regulations of the Environmental Protection Agency (EPA) and the Commonwealth of Virginia. This inspection was performed using current EPA AHERA standards. This protocol was used for the determination, sampling and analysis of suspected Asbestos Containing Materials (ACM).

## ASBESTOS INSPECTION

An inspection of the structure at 3906 Rutrough Road was performed February 12, 2019 by representatives of HDHT. The objective of this inspection was to determine the location of suspect asbestos-containing materials (ACM) currently located on the interior or exterior of this structure that may be disturbed by upcoming demolition activities.

As the sample summary indicates, the following suspect materials sampled were reported to be asbestos containing by the laboratory:

- **Linoleum – Green – Under Stairwell in Closet**
- **Linoleum – Green – In exterior access room under carpet**
- **Felt Paper – Under Wood Shingle Siding – Shed behind house**

These NON-Friable asbestos containing materials should be removed prior to demolition activities at this location. Removal should be performed by licensed, contract personnel using approved methods.

**For informational purposes, the following suspect material was reported to contain asbestos at < 1%. Although not considered an Asbestos Containing Material (> 1%), this information should be provided to all contract personnel prior to restoration/demolition activities for their use in meeting current OSHA requirements pertaining to personnel disturbing this material:**

- **Sheetrock Joint Compound**

*Friable Asbestos Material:* Material when dry, may be crumbled, pulverized or reduced to powder by hand pressure and includes previously non-friable material after such previously non-friable material becomes damaged to the extent that when dry is may be crumbled, pulverized, or reduced to powder by hand pressure.

*Non-friable Asbestos Material:* Material that contains asbestos in which the fibers have been locked in by a bonding agent, coating, binder, or other material so that the asbestos is well bound and will not release fibers during any appropriate use, handling, demolition, storage, transportation, processing or disposal.

This information should be provided to all contract personnel for their use in meeting current OSHA requirements. Every attempt was made to gain access to all areas or to assess representative materials entering or leaving the area. HDH Technical, Inc. accepts no liability nor makes any claims regarding ACBM which was not accessible during the inspection process if such material was located behind or within walls, concrete decks, subfloors, or was generally inaccessible without destructive sampling. If any additional suspect materials are identified during the course of the project, the contractor is to immediately stop work and contact the Owner for further direction.

---

## Sample Summary

# 3906 Ruthrough Road

LAB #	SAMPLE ID	SAMPLE DESCRIPTION	RESULT	%
19006501 -001	SR 1.1	Sheetrock - downstairs	ND	-
19006501 -002	SR 1.2	Sheetrock - downstairs	ND	-
19006501 -003	SR 1.3	Sheetrock - downstairs	ND	-
19006501 -004	JC 2.1	Joint Compound - downstairs	ND	-
19006501 -005	JC 2.2	Joint Compound - downstairs	ND	-
1900803 -001	JC 2.3	Joint Compound - downstairs	■	.05% *
19006501 -007	FT 3.1	Floor Tile 12x12 - Laundry	ND	-
19006501 -008	FT 3.2	Floor Tile 12x12 - Laundry	ND	-
19006501 -009	FT 4.1	Floor Tile 12x12 - Downstairs Bathroom	ND	-
19006501 -010	FT 4.2	Floor Tile 12x12 - Downstairs Bathroom	ND	-
19006501 -011	FT 5.1	Linoluem - Green - under stairwell	■	20%
19006501 -012	FT 5.2	Linoluem - Green - under stairwell	NA	PS
19006501 -013	FP 6.1	Felt Paper under wood siding	ND	-
19006501 -014	FP 6.2	Felt Paper under wood siding	ND	-
19006501 -015	FT 7.1	Floor Tile 12x12 - upstairs bathroom	ND	-
19006501 -016	FT 7.2	Floor Tile 12x12 - upstairs bathroom	ND	-
19006501 -017	CM 8.1	Construction Mastic under paneling	ND	-
19006501 -018	CM 8.2	Construction Mastic under paneling	ND	-
19006501 -019	SR 9.1	Sheetrock	ND	-
19006501 -020	SR 9.2	Sheetrock	ND	-
19006501 -021	SR 9.3	Sheetrock	ND	-
1900803 -002	JC 10.1	Joint Compound	■	<0.25% *
19006501 -023	JC 10.2	Joint Compound	NA	PS
19006501 -024	JC 10.3	Joint Compound	NA	PS
19006501 -024	PW 11.1	Plaster Wall	ND	-
19006501 -026	PW 11.2	Plaster Wall	ND	-
19006501 -027	PW 11.3	Plaster Wall	ND	-
19006501 -028	WG 12.1	Window Glazing	ND	-
19006501 -029	WG 12.2	Window Glazing	ND	-
19006501 -030	LN 13.1	Linoleum - Green- Rear Workshop	■	20%
19006501 -031	LN 13.2	Linoleum - Green- Rear Workshop	NA	PS
19006501 -032	RS 14.1	Roof Shingle - House	ND	-

\* As determined by Point Count Analysis

ND = NONE DETECTED

NA = NOT ANALYZED  
POSITIVE STOP



= CHRYSOTILE



= AMOSITE



= OTHER



3906 Ruthrough Road

[illegible]

**ND = NONE DETECTED**

NA = NOT ANALYZED  
POSITIVE STOP

■ = CHRYSOTILE

▲ = AMOSITE

⊙ = OTHER

---

# Laboratory Report



1551 Oakbridge Drive Suite B  
Powhatan, VA 23139  
804-807-1177 / 888-895-1175  
Fax 804-897-0070  
www.sanair.com

Asbestos  
Chain of Custody

SanAir ID Number

19006601

Company: HDH Technical, Inc		Project #: County of Roanoke	Collected by: Danner
Address: 400 West Main Street		Project Name: 3906 Rutrough Rd Roanoke, VA	Phone #: 540-381-7999
City, St, Zip: Christiansburg, VA 24073		Date Collected: 2/12/2019	Email: rliebal@hdhassociates.com
State of Collection: VA Account #: 1769		P.O. Number: Parks, Recreation & Tourism	Email: fdanner@hdhassociates.com

Bulk		
ABB	PLM EPA 600/R-93/116	<input checked="" type="checkbox"/>
	Positive Stop	<input checked="" type="checkbox"/>
ABEPA	PLM EPA 400 Point Count	<input type="checkbox"/>
ABB1K	PLM EPA 1000 Point Count	<input type="checkbox"/>
ABBEN	PLM EPA NOB	<input type="checkbox"/>
ABBCH	TEM Chatfield	<input type="checkbox"/>
ABBTM	TEM EPA NOB	<input type="checkbox"/>

Air		
ABA	PCM NIOSH 7400	<input type="checkbox"/>
ABA-2	OSHA w TWA	<input type="checkbox"/>
ABTEM	TEM AHERA	<input type="checkbox"/>
ABATN	TEM NIOSH 7402	<input type="checkbox"/>
ABT2	TEM Level II	<input type="checkbox"/>

Soil/Vermiculite		
ABSE	PLM EPA 600/R-93/116 (Qual )	<input type="checkbox"/>
ABSP	PLM CARB 435 (LOD <1%)	<input type="checkbox"/>
ABSP1	PLM CARB 435 (LOD 0.25%)	<input type="checkbox"/>
ABSP2	PLM CARB 435 (LOD 0.1%)	<input type="checkbox"/>

Water		
ABHE	EPA 100.2	<input type="checkbox"/>

New York ELAP		
PLM NY	PLM EPA 600/M4-82-020	<input type="checkbox"/>
ABEPA2	NY ELAP 198.1	<input type="checkbox"/>
ABENY	NY ELAP 198.6 PLM NOB	<input type="checkbox"/>
ABBNY	NY ELAP 198.4 TEM NOB	<input type="checkbox"/>

Dust		
ABWA	TEM Wipe ASTM D-6480	<input type="checkbox"/>
ABDMV	TEM Microvac ASTM D-5755	<input type="checkbox"/>

Matrix	Other	<input type="checkbox"/>	<input type="checkbox"/>
--------	-------	--------------------------	--------------------------

Turn Around Times	3 HR (4 HR TEM)	6 HR (8HR TEM)	12 HR	24 HR
	2 Days	3 Days	4 Days	5 Days

Special Instructions:	
-----------------------	--

SAMPLE ID	SAMPLE DESCRIPTION
SR 1.1	Sheetrock - downstairs
SR 1.2	Sheetrock - downstairs
SR 1.3	Sheetrock - downstairs
JC 2.1	Joint Compound - downstairs
JC 2.2	Joint Compound - downstairs
JC 2.3	Joint Compound - downstairs
FT 3.1	Floor Tile 12x12 - Laundry
FT 3.2	Floor Tile 12x12 - Laundry
FT 4.1	Floor Tile 12x12 - Downstairs Bathroom
FT 4.2	Floor Tile 12x12 - Downstairs Bathroom
FT 5.1	Linoluem - Green - under stairwell

Special Instructions	
----------------------	--

Relinquished by	Date	Time	Received by	Date	Time
Fred Danner	2/12/2019	3:42 PM	FedEx	2/12/2019	3:42 PM
			MLB	FEB 13 2019	10:54

Unless scheduled, the turn around time for all samples received after 3 pm EST Friday will begin at 8 am Monday morning. Weekend or Holiday work must be scheduled ahead of time and is charged for rush turn around time. Work with standard turn around time sent Priority Overnight and Billed to Recipient will be charged a \$10 shipping fee.

19006501

SAMPLE ID	SAMPLE DESCRIPTION
FT 5.2	Linoluem - Green - under stairwell
FP 6.1	Felt Paper under wood siding
FP 6.2	Felt Paper under wood siding
FT 7.1	Floor Tile 12x12 - upstairs bathroom
FT 7.2	Floor Tile 12x12 - upstairs bathroom
CM 8.1	Construction Mastic under paneling
CM 8.2	Construction Mastic under paneling
SR 9.1	Sheetrock
SR 9.2	Sheetrock
SR 9.3	Sheetrock
JC 10.1	Joint Compound
JC 10.2	Joint Compound
JC 10.3	Joint Compound
PW 11.1	Plaster Wall
PW 11.2	Plaster Wall
PW 11.3	Plaster Wall
WG 12.1	Window Glazing
WG 12.2	Window Glazing
LN 13.1	Linoleum - Green- Rear Workshop
LN 13.2	Linoleum - Green- Rear Workshop
RS 14.1	Roof Shingle - House
RS 14.2	Roof Shingle - House
FP 15.1	Felt Paper - Under RS 14
FP 15.2	Felt Paper - Under RS 14
RR 16.1	Rolled Roofing- Rear Workshop
RR 16.2	Rolled Roofing- Rear Workshop
FP 17.1	Felt Paper - Under RR 16

Special Instructions	
----------------------	--

Relinquished by	Date	Time	Received by	Date	Time
Fred Danner	2/12/2019	3:42 PM	FedEx	2/12/2019	3:42 PM
			<i>MB</i>	FEB 13 2019	10:54

Unless scheduled, the turn around time for all samples received after 3 pm EST Friday will begin at 8 am Monday morning. Weekend or Holiday work must be scheduled ahead of time and is charged for rush turn around time. Work with standard turn around time sent Priority Overnight and Billed to Recipient will be charged a \$10 shipping fee.

19006501

[illegible]

Special Instructions	
----------------------	--

Relinquished by	Date	Time	Received by	Date	Time
Fred Danner	2/12/2019	3:42 PM	FedEx	2/12/2019	3:42 PM
			<i>MB</i>	FEB 13 2019	10:54

Unless scheduled, the turn around time for all samples received after 3 pm EST Friday will begin at 8 am Monday morning. Weekend or Holiday work must be scheduled ahead of time and is charged for rush turn around time. Work with standard turn around time sent Priority Overnight and Billed to Recipient will be charged a \$10 shipping fee.

Page 3 of 3

CAMDF ID	CAMDF DESCRIPTION
----------	-------------------





SanAir ID Number

19006501

FINAL REPORT

2/14/2019 11:03:44 AM

Name: HDH Technical, Inc.

Address: P.O. Box 6158

Christiansburg, VA 24073

Phone: 540-381-7999

Project Number: County Of Roanoke

P.O. Number: Parks, Recreation &amp; Tourism

Project Name: 3906 Rutrough Rd Roanoke, VA

Collected Date: 2/12/2019

Received Date: 2/13/2019 10:15:00 AM

Analyst: Childress, Susan

**Asbestos Bulk PLM EPA 600/R-93/116**

SanAir ID / Description	Stereoscopic	Components		Asbestos Fibers
	Appearance	% Fibrous	% Non-fibrous	
SR 1.1 / 19006501-001 Sheetrock-Downstairs	Grey Non-Fibrous Homogeneous	4% Cellulose	96% Other	None Detected
SR 1.2 / 19006501-002 Sheetrock-Downstairs	Grey Non-Fibrous Homogeneous	4% Cellulose	96% Other	None Detected
SR 1.3 / 19006501-003 Sheetrock-Downstairs	Grey Non-Fibrous Homogeneous	4% Cellulose	96% Other	None Detected
JC 2.1 / 19006501-004 Joint Compound-Downstairs	White Non-Fibrous Homogeneous		100% Other	None Detected
JC 2.2 / 19006501-005 Joint Compound-Downstairs	White Non-Fibrous Homogeneous		100% Other	None Detected
JC 2.3 / 19006501-006 Joint Compound-Downstairs	White Non-Fibrous Homogeneous		98% Other	2% Chrysotile
FT 3.1 / 19006501-007 Floor Tile 12x12-Laundry	Beige Non-Fibrous Homogeneous		100% Other	None Detected
FT 3.2 / 19006501-008 Floor Tile 12x12-Laundry	Beige Non-Fibrous Homogeneous		100% Other	None Detected
FT 4.1 / 19006501-009 Floor Tile 12x12-Downstairs Bathroom, Floor Tile	Brown Non-Fibrous Homogeneous		100% Other	None Detected
FT 4.1 / 19006501-009 Floor Tile 12x12-Downstairs Bathroom, Mastic	Yellow Non-Fibrous Homogeneous		100% Other	None Detected

Analyst:

*Susan P. Childress*

Approved Signatory:

*Johnathan Wilson*

Analysis Date: 2/14/2019

Date: 2/14/2019



SanAir ID Number

19006501

FINAL REPORT

2/14/2019 11:03:44 AM

Name: HDH Technical, Inc.

Address: P.O. Box 6158

Christiansburg, VA 24073

Phone: 540-381-7999

Project Number: County Of Roanoke

P.O. Number: Parks, Recreation &amp; Tourism

Project Name: 3906 Rutrough Rd Roanoke, VA

Collected Date: 2/12/2019

Received Date: 2/13/2019 10:15:00 AM

Analyst: Childress, Susan

**Asbestos Bulk PLM EPA 600/R-93/116**

SanAir ID / Description	Stereoscopic	Components		Asbestos Fibers
	Appearance	% Fibrous	% Non-fibrous	
FT 4.2 / 19006501-010 Floor Tile 12x12-Downstairs Bathroom, Floor Tile	Brown Non-Fibrous Homogeneous		100% Other	None Detected
FT 4.2 / 19006501-010 Floor Tile 12x12-Downstairs Bathroom, Mastic	Yellow Non-Fibrous Homogeneous		100% Other	None Detected
FT 5.1 / 19006501-011 Linoleum-Under Stairwell	Green Fibrous Homogeneous	35% Cellulose	45% Other	20% Chrysotile
FT 5.2 / 19006501-012 Linoleum-Under Stairwell				Not Analyzed
FP 6.1 / 19006501-013 Felt Paper Under Wood Siding	Black Fibrous Homogeneous	50% Cellulose	50% Other	None Detected
FP 6.2 / 19006501-014 Felt Paper Under Wood Siding	Black Fibrous Homogeneous	50% Cellulose	50% Other	None Detected
FT 7.1 / 19006501-015 Floor Tile 12x12-Upstairs Bathroom	Yellow Non-Fibrous Homogeneous		100% Other	None Detected
FT 7.2 / 19006501-016 Floor Tile 12x12-Upstairs Bathroom	Yellow Non-Fibrous Homogeneous		100% Other	None Detected
CM 8.1 / 19006501-017 Construction Mastic Under Paneling	Tan Non-Fibrous Homogeneous		100% Other	None Detected
CM 8.2 / 19006501-018 Construction Mastic Under Paneling	Tan Non-Fibrous Homogeneous		100% Other	None Detected

Analyst: *Susan P. Childress* Approved Signatory: *Johnathan Wilson*

Analysis Date: 2/14/2019

Date: 2/14/2019





SanAir ID Number

19006501

FINAL REPORT

2/14/2019 11:03:44 AM

Name: HDH Technical, Inc.

Address: P.O. Box 6158

Christiansburg, VA 24073

Phone: 540-381-7999

Project Number: County Of Roanoke

P.O. Number: Parks, Recreation &amp; Tourism

Project Name: 3906 Rutrough Rd Roanoke, VA

Collected Date: 2/12/2019

Received Date: 2/13/2019 10:15:00 AM

Analyst: Childress, Susan

**Asbestos Bulk PLM EPA 600/R-93/116**

SanAir ID / Description	Stereoscopic	Components		Asbestos Fibers
	Appearance	% Fibrous	% Non-fibrous	
SR 9.1 / 19006501-019 Sheetrock	Grey Non-Fibrous Homogeneous	4% Cellulose	96% Other	None Detected
SR 9.2 / 19006501-020 Sheetrock	Grey Non-Fibrous Homogeneous	4% Cellulose	96% Other	None Detected
SR 9.3 / 19006501-021 Sheetrock	Grey Non-Fibrous Homogeneous	4% Cellulose	96% Other	None Detected
JC 10.1 / 19006501-022 Joint Compound	White Non-Fibrous Homogeneous		98% Other	2% Chrysotile
JC 10.2 / 19006501-023 Joint Compound				Not Analyzed
JC 10.3 / 19006501-024 Joint Compound				Not Analyzed
PW 11.1 / 19006501-025 Plaster Wall, Plaster	Grey Non-Fibrous Homogeneous	< 1% Hair	100% Other	None Detected
PW 11.1 / 19006501-025 Plaster Wall, Skim Coat	White Non-Fibrous Homogeneous		100% Other	None Detected
PW 11.2 / 19006501-026 Plaster Wall, Plaster	Grey Non-Fibrous Homogeneous	< 1% Hair	100% Other	None Detected
PW 11.2 / 19006501-026 Plaster Wall, Skim Coat	White Non-Fibrous Homogeneous		100% Other	None Detected

Analyst:

*Susan P. Childress*

Approved Signatory:

*Johnathan Wilson*

Analysis Date: 2/14/2019

Date: 2/14/2019





SanAir ID Number

19006501

FINAL REPORT

2/14/2019 11:03:44 AM

Name: HDH Technical, Inc.  
Address: P.O. Box 6158  
Christiansburg, VA 24073  
Phone: 540-381-7999

Project Number: County Of Roanoke  
P.O. Number: Parks, Recreation & Tourism  
Project Name: 3906 Rutrough Rd Roanoke, VA  
Collected Date: 2/12/2019  
Received Date: 2/13/2019 10:15:00 AM

Analyst: Childress, Susan

**Asbestos Bulk PLM EPA 600/R-93/116**

SanAir ID / Description	Stereoscopic	Components		Asbestos Fibers
	Appearance	% Fibrous	% Non-fibrous	
PW 11.3 / 19006501-027 Plaster Wall, Plaster	Grey Non-Fibrous Homogeneous	< 1% Hair	100% Other	None Detected
PW 11.3 / 19006501-027 Plaster Wall, Skim Coat	White Non-Fibrous Homogeneous		100% Other	None Detected
PW 11.3 / 19006501-027 Plaster Wall, Texture	White Non-Fibrous Homogeneous		100% Other	None Detected
WG 12.1 / 19006501-028 Window Glazing	Beige Non-Fibrous Homogeneous		100% Other	None Detected
WG 12.2 / 19006501-029 Window Glazing	Beige Non-Fibrous Homogeneous		100% Other	None Detected
LN 13.1 / 19006501-030 Linoleum-Rear Workshop	Green Fibrous Homogeneous	35% Cellulose	45% Other	20% Chrysotile
LN 13.2 / 19006501-031 Linoleum-Rear Workshop				Not Analyzed
RS 14.1 / 19006501-032 Roof Shingle-House	Various Non-Fibrous Heterogeneous	10% Glass	90% Other	None Detected
RS 14.2 / 19006501-033 Roof Shingle-House	Various Non-Fibrous Heterogeneous	10% Glass	90% Other	None Detected
FP 15.1 / 19006501-034 Felt Paper-Under RS 14	Black Fibrous Homogeneous	60% Cellulose	40% Other	None Detected

Analyst:

*Susan P. Childress*

Approved Signatory:

*Johnathan Wilson*

Analysis Date: 2/14/2019

Date: 2/14/2019



SanAir ID Number

19006501

FINAL REPORT

2/14/2019 11:03:44 AM

Name: HDH Technical, Inc.  
Address: P.O. Box 6158  
Christiansburg, VA 24073  
Phone: 540-381-7999

Project Number: County Of Roanoke  
P.O. Number: Parks, Recreation & Tourism  
Project Name: 3906 Rutrough Rd Roanoke, VA  
Collected Date: 2/12/2019  
Received Date: 2/13/2019 10:15:00 AM

Analyst: Childress, Susan

**Asbestos Bulk PLM EPA 600/R-93/116**

SanAir ID / Description	Stereoscopic	Components		Asbestos Fibers
	Appearance	% Fibrous	% Non-fibrous	
FP 15.2 / 19006501-035 Felt Paper-Under RS 14	Black Fibrous Homogeneous	60% Cellulose	40% Other	None Detected
RR 16.1 / 19006501-036 Rolled Roof-Rear Workshop	Black Non-Fibrous Heterogeneous	20% Cellulose	80% Other	None Detected
RR 16.2 / 19006501-037 Rolled Roof-Rear Workshop	Black Non-Fibrous Heterogeneous	20% Cellulose	80% Other	None Detected
FP 17.1 / 19006501-038 Felt Paper-Under RR 16	Brown Fibrous Homogeneous	60% Cellulose	40% Other	None Detected
FP 17.2 / 19006501-039 Felt Paper-Under RR 16	Brown Fibrous Homogeneous	60% Cellulose	40% Other	None Detected
RS 18.1 / 19006501-040 Roof Shingle-Carport	Black Non-Fibrous Heterogeneous	10% Glass	90% Other	None Detected
RS 18.2 / 19006501-041 Roof Shingle-Carport	Black Non-Fibrous Heterogeneous	10% Glass	90% Other	None Detected
FP 19.1 / 19006501-042 Felt Paper-Under RS 18	Black Fibrous Homogeneous	50% Cellulose	50% Other	None Detected
FP 19.2 / 19006501-043 Felt Paper-Under RS 18	Black Fibrous Homogeneous	50% Cellulose	50% Other	None Detected
FP 20.1 / 19006501-044 Felt Paper-Under Wood Siding-Shed	Brown Fibrous Homogeneous	60% Cellulose	30% Other	10% Chrysotile

Analyst:

*Susan P. Childress*

Approved Signatory:

*Johnathan Wilson*

Analysis Date: 2/14/2019

Date: 2/14/2019





SanAir ID Number

19006501

FINAL REPORT

2/14/2019 11:03:44 AM

**Name:** HDH Technical, Inc.

**Address:** P.O. Box 6158

Christiansburg, VA 24073

**Phone:** 540-381-7999

**Project Number:** County Of Roanoke

**P.O. Number:** Parks, Recreation & Tourism

**Project Name:** 3906 Rutrough Rd Roanoke, VA

**Collected Date:** 2/12/2019

**Received Date:** 2/13/2019 10:15:00 AM

Analyst: Childress, Susan

### Asbestos Bulk PLM EPA 600/R-93/116

SanAir ID / Description	Stereoscopic	Components		Asbestos Fibers
	Appearance	% Fibrous	% Non-fibrous	
FP 20.2 / 19006501-045 Felt Paper-Under Wood Siding-Shed				Not Analyzed
WG 21.1 / 19006501-046 Window Glazing-Shed	Black Non-Fibrous Homogeneous		100% Other	None Detected
WG 21.2 / 19006501-047 Window Glazing-Shed	Black Non-Fibrous Homogeneous		100% Other	None Detected

Analyst:

*Susan P. Childress*

Approved Signatory:

*Johnathan Wilson*

Analysis Date: 2/14/2019

Date: 2/14/2019



SanAir ID Number

19006803

FINAL REPORT

2/15/2019 1:37:57 PM

**Name:** HDH Technical, Inc.

**Address:** P.O. Box 6158

Christiansburg, VA 24073

**Phone:** 540-381-7999

**Project Number:** County Of Roanoke

**P.O. Number:** Parks, Recreation & Tourism

**Project Name:** 3906 Rutrough Rd Roanoke, VA

**Collected Date:** 2/12/2019

**Received Date:** 2/15/2019 8:00:00 AM

Analyst: Tallert, Jonathan

### Asbestos Bulk EPA PLM 400 Point Count

SanAir ID / Description	Stereoscopic	Components		Asbestos Fibers
	Appearance	% Fibrous	% Non-fibrous	
JC 2.3 / 19006803-001 Joint Compound - Downstairs	White Non-Fibrous Homogeneous		99.5% Other	0.5% Chrysotile
JC 10.1 / 19006803-002 Joint Compound	White Non-Fibrous Homogeneous		100% Other	< 0.25% Chrysotile

Analyst:

Approved Signatory:

Analysis Date: 2/15/2019

Date: 2/15/2019

### **Disclaimer**

The final report cannot be reproduced, except in full, without written authorization from SanAir. Fibers smaller than 5 microns cannot be seen with this method due to scope limitations. The accuracy of the results is dependent upon the client's sampling procedure and information provided to the laboratory by the client. SanAir assumes no responsibility for the sampling procedure and will provide evaluation reports based solely on the sample and information provided by the client. This report may not be used by the client to claim product endorsement by NVLAP or any other agency of the U.S. government. Samples are held for a period of 60 days.

For NY state samples, method EPA 600/M4-82-020 is performed.

Polarized- light microscopy is not consistently reliable in detecting asbestos in floor covering and similar non-friable organically bound materials. Quantitative transmission electron microscopy is currently the only method that can be used to determine if this material can be considered or treated as non-asbestos containing.

#### **Asbestos Certifications**

NVLAP lab code 200870

City of Philadelphia: ALL-460

PA Department of Environmental Protection Number: 68-05397

California License Number: 2915

Colorado License Number: AL-23143

Connecticut License Number: PH-0105

Massachusetts License Number: AA000222

Maine License Number: LB-0075

New York ELAP lab ID: 11983

Rhode Island License Number: AAL-126

Texas Department of State Health Services License Number: 300440

Commonwealth of Virginia 3333000323

Washington State License Number: C989

West Virginia License Number: LT000566

Vermont License: AL166318



SanAir ID Number

19006501

FINAL REPORT

2/14/2019 11:03:44 AM

**Name:** HDH Technical, Inc.

**Address:** P.O. Box 6158

Christiansburg, VA 24073

**Phone:** 540-381-7999

**Project Number:** County Of Roanoke

**P.O. Number:** Parks, Recreation & Tourism

**Project Name:** 3906 Rutrough Rd Roanoke, VA

**Collected Date:** 2/12/2019

**Received Date:** 2/13/2019 10:15:00 AM

Dear Fred Danner,

We at SanAir would like to thank you for the work you recently submitted. The 47 sample(s) were received on Wednesday, February 13, 2019 via FedEx. The final report(s) is enclosed for the following sample(s): SR 1.1, SR 1.2, SR 1.3, JC 2.1, JC 2.2, JC 2.3, FT 3.1, FT 3.2, FT 4.1, FT 4.2, FT 5.1, FT 5.2, FP 6.1, FP 6.2, FT 7.1, FT 7.2, CM 8.1, CM 8.2, SR 9.1, SR 9.2, SR 9.3, JC 10.1, JC 10.2, JC 10.3, PW 11.1, PW 11.2, PW 11.3, WG 12.1, WG 12.2, LN 13.1, LN 13.2, RS 14.1, RS 14.2, FP 15.1, FP 15.2, RR 16.1, RR 16.2, FP 17.1, FP 17.2, RS 18.1, RS 18.2, FP 19.1, FP 19.2, FP 20.1, FP 20.2, WG 21.1, WG 21.2.

These results only pertain to this job and should not be used in the interpretation of any other job. This report is only complete in its entirety. Refer to the listing below of the pages included in a complete final report.

Sincerely,

A handwritten signature in black ink that reads "Sandra Sobrino". The signature is written in a cursive, flowing style.

Sandra Sobrino  
Asbestos & Materials Laboratory Manager  
SanAir Technologies Laboratory

**Final Report Includes:**

- Cover Letter
- Analysis Pages
- Disclaimers and Additional Information

**Sample conditions:**

- 47 samples in Good condition.

---

## Photos



## 3906 Rutrough Road

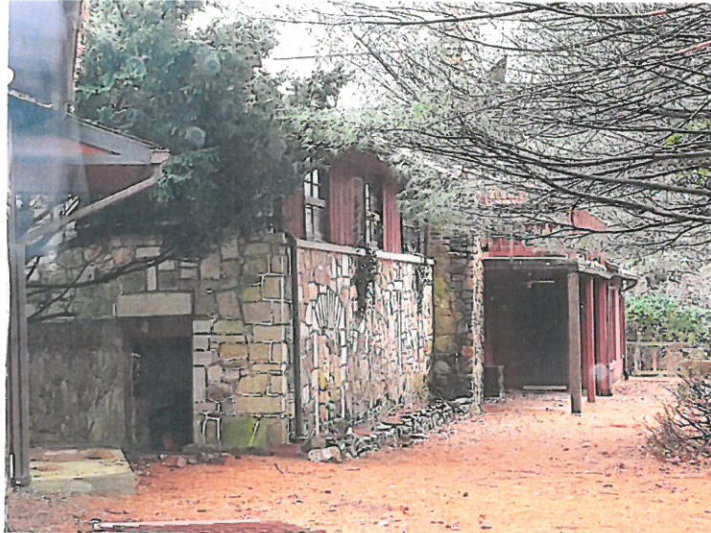

**The Linoleum located in the under stair closet was found to be Asbestos Containing by the laboratory.**



## 3906 Rutrough Road



**The Linoleum located in the rear workshop (Exterior Access Room) under carpet was found to be Asbestos Containing by the laboratory.**



**The Felt Paper located under wooden shingle siding on the shed behind the home was found to be Asbestos Containing by the laboratory.**

---

## Applicable Licenses

COMMONWEALTH of VIRGINIA

Department of Professional and Occupational Regulation

9960 Mayland Drive, Suite 400, Richmond, VA 23233

Telephone: (804) 367-8500

EXPIRES ON

05-31-2019

NUMBER

3303004166

BOARD FOR ASBESTOS, LEAD, AND HOME INSPECTORS  
ASBESTOS INSPECTOR LICENSE



FREDERICK REED DANNER  
400 WEST MAIN ST  
CHRISTIANSBURG, VA 24073-0000



Status can be verified at <http://www.dpor.virginia.gov>

*Jay W. DeBoer*  
Jay W. DeBoer Director

(SEE REVERSE SIDE FOR PRIVILEGES AND INSTRUCTIONS)

DPOR-LIC (02/2017)