

# Dry Hollow Road Safety Improvements Project History

- **1998:** Board of Supervisors added the project to the VDOT Six Year Plan for 1998-2004, under the old system
- **2009:** Project removed from the VDOT Six Year Plan due to Recession funding cuts and restructuring
- **2013:** County staff investigated safety alternatives with VDOT
- **2014:** County applied for and received Revenue Sharing funding for a portion of the project (Fiscal Years 2016 and 2017 funding)
- **2017:** Board of Supervisors added the project to the Secondary Six-Year Plan to fund the project deficit
- **2019:** VDOT began Preliminary Engineering



# Existing Conditions

- Narrow roadway width (one lane under bridge)
- Limited sight distance due to the road curving under the railroad bridge
- Norfolk Southern Historic Railroad Bridge
- Dry Hollow Creek shares space under the bridge and floods the roadway
- A rock wall holds the roadway above the creek
- Only access to approximately 60 households and to Camp Roanoke
- Road also provides access to Spring Hollow Reservoir

## Project Goals

1. Reinforce roadway against the creek to reduce possibility of the roadway failing.
2. Improve safety by widening the roadway for two-way travel.

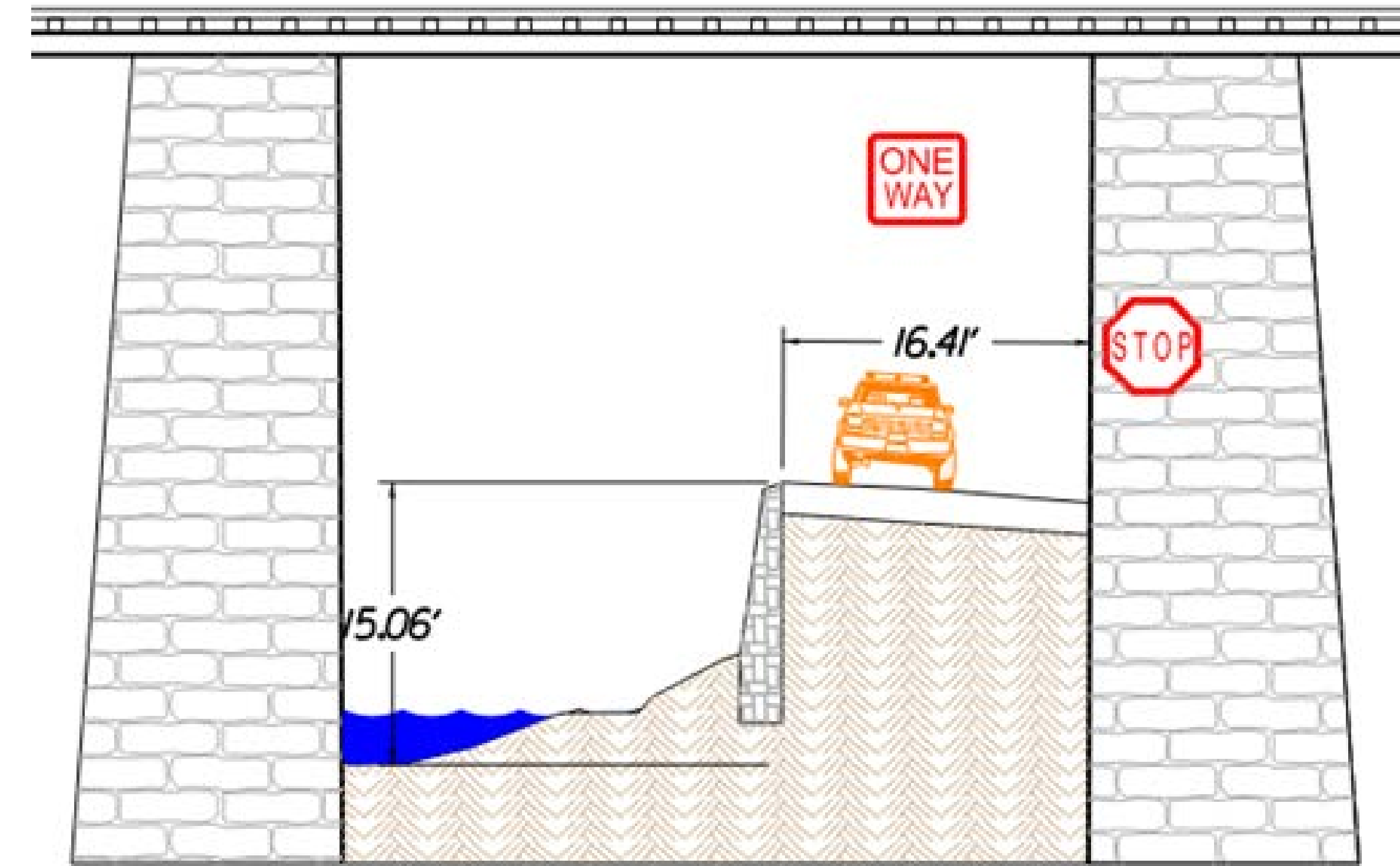

Existing Cross Section under Railroad Bridge



Existing Rock Wall between Roadway and Creek



# Proposed Phase 1: Construction in 2022

Reinforce roadway against the creek to reduce the possibility of the roadway failing.

1. Install a soil nail wall at the creek to stabilize the roadway and to prepare for the double box culvert proposed in Phase 2.
2. Install a modular block wall in front of the soil nail wall.

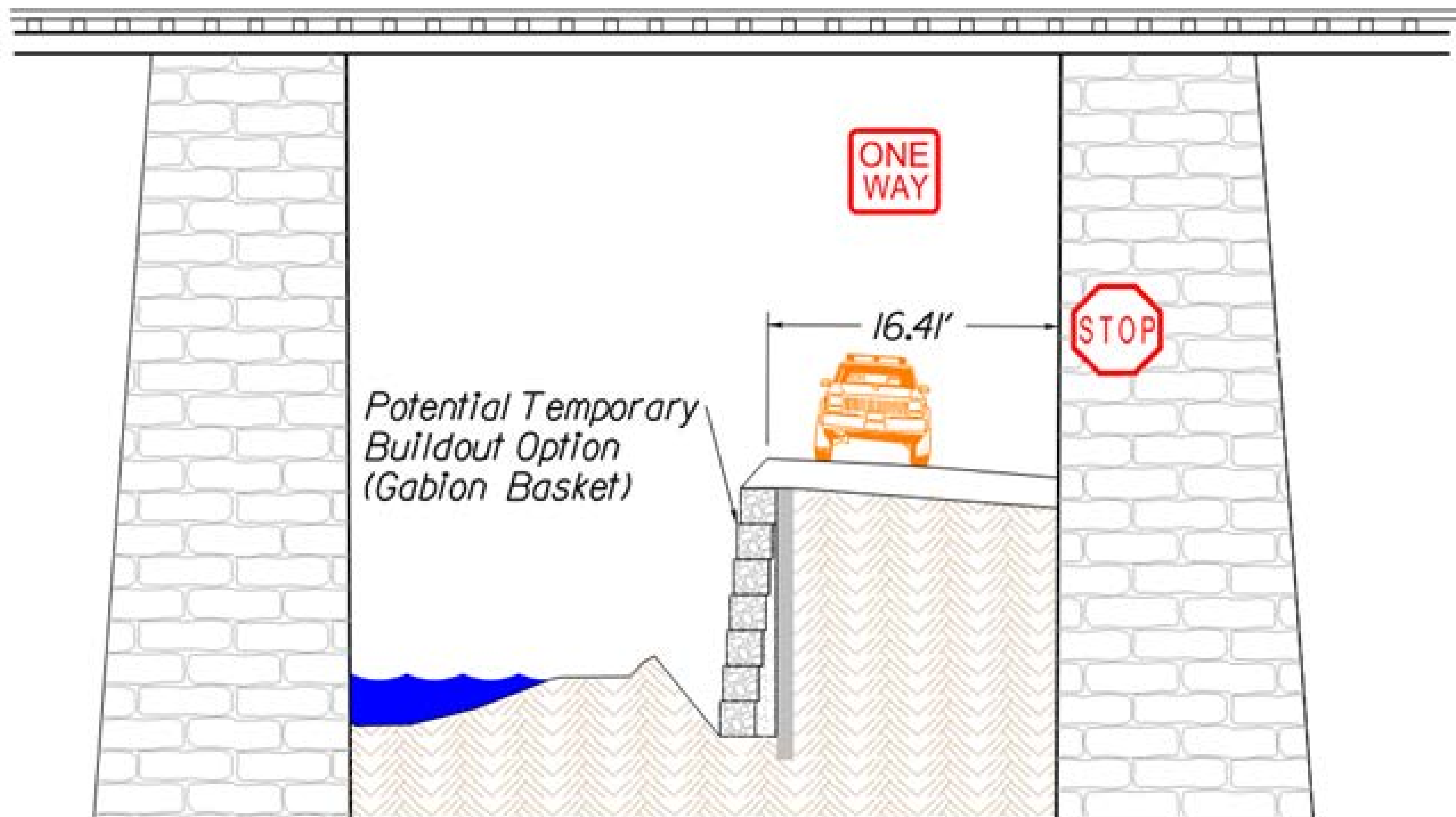



# Proposed Phase 2: Construction when Funding is Obtained and Available

Improve safety by widening the roadway for two-way travel.

1. Remove the modular block wall.
2. Install double 10x10x130-foot-long box culverts under the bridge for the creek and extend the roadway onto the culverts to construct an 18-foot-wide roadway with two-foot-wide shoulders.

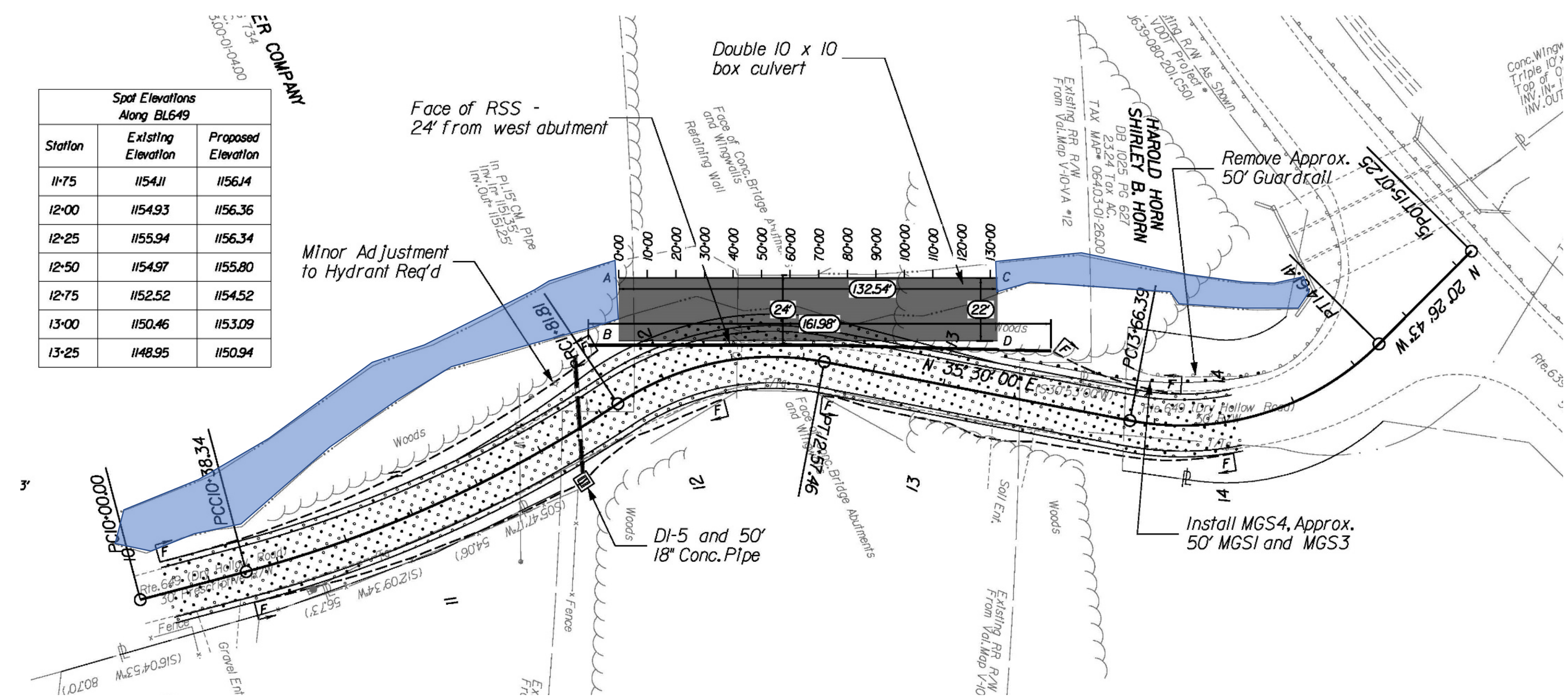
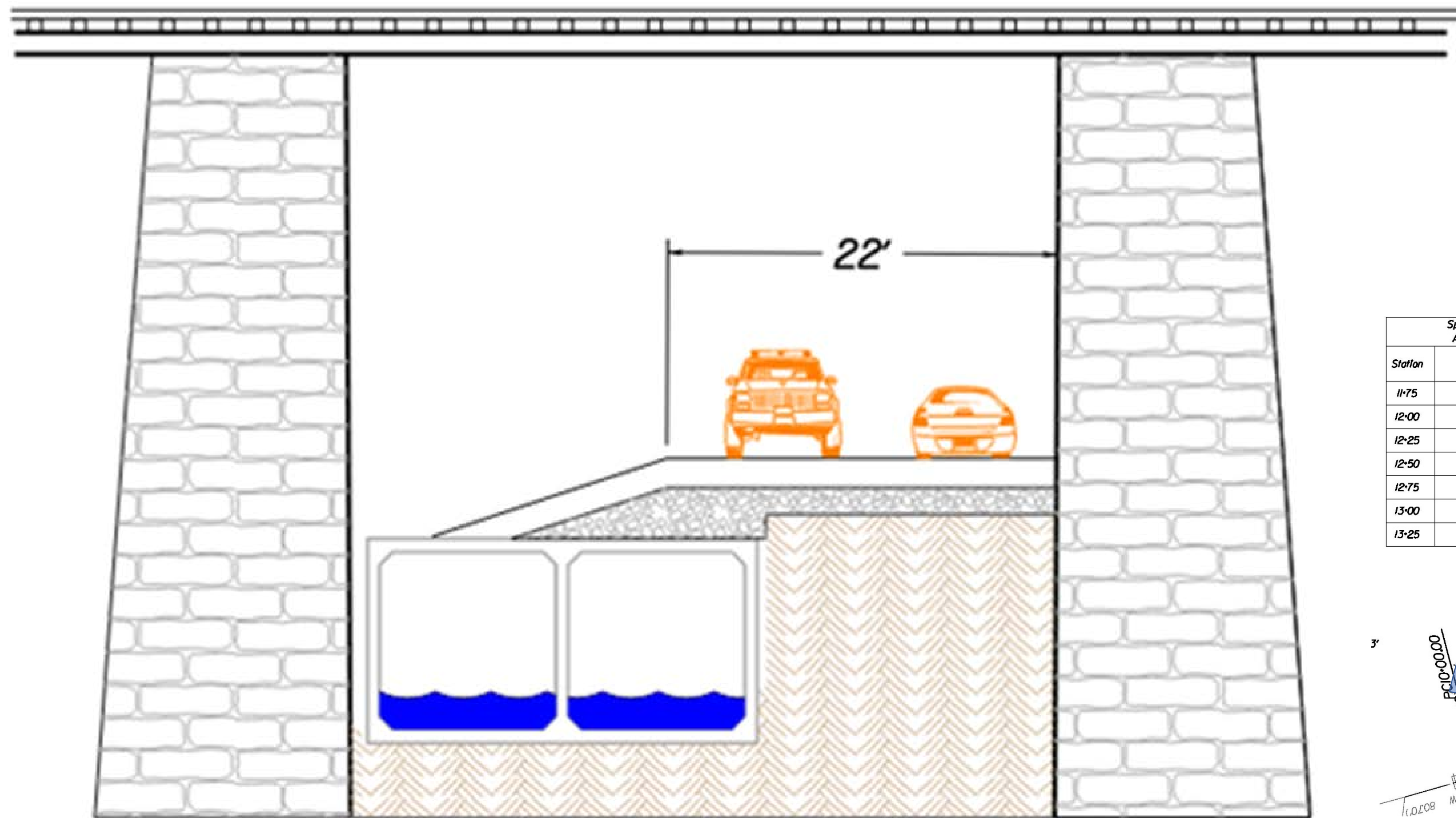



# Project Funding

Current project funding (2017 estimate): **\$2,185,000**

- Revenue Sharing: \$1,226,000 (50/50 VDOT/County funding)
- Secondary Six-Year Plan: \$959,000 (100% VDOT funding)

Updated cost (2021 estimate): **\$4,785,000**

- Most of the increase is due to the expense of purchasing, making room for and installing double 130-foot-long culverts that were not anticipated at the start of the project.

Current deficit: **\$2,505,236**

County Share (50% through VDOT Revenue Sharing): **\$1,252,618**

- A Revenue Sharing application was submitted in October 2021.
- Awards will be finalized in June 2022, though funding will not be available until later years.

# Status Update and Next Steps

- **Mid-November 2021 through mid-January 2022:** VDOT will be gathering field information in the vicinity of the project site.
- **First half of 2022:** VDOT will hold a Citizen Information Meeting to share additional project details and will mail letters to impacted property owners notifying them about the project and asking if they would like VDOT to hold a public hearing (called a Willingness to Hold a Public Hearing).
- **June 2022:** Final Revenue Sharing Program awards will be announced. Phase 2 construction depends upon whether or not additional project funding is awarded.
- **Second half of 2022:** Phase 1 construction is anticipated to begin.



# Roanoke County 200 Plan Community Meetings



Remaining Fall meetings are  
open-house style  
from 4:00 p.m. to 8:00 p.m.

- **Back Creek:** Back Creek Elem. School - Thursday, October 28
- **Bent Mountain:** Bent Mountain Center - Thursday, November 4
- **Glenvar:** Fort Lewis Elementary School - Monday, November 8
- **South County:** South County Library – Wednesday, Nov. 17
- **North County:** Green Ridge Center – Thursday, November 18